



Gardenreet® Premium Brass Landscape Lighting
Brass Pond Light – Classic Model: Pondlight-2801

Solid Brass Pond Light



Solid Brass | Lifetime Warranty | Pre-aged Finish

WARRANTY&CERTIFICATION



PRODUCT DESCRIPTION

Constructed from premium **solid brass**, this fixture delivers exceptional **corrosion resistance** and long-term durability in demanding outdoor environments. The fixture design supports **MR16 bulbs**, allowing easy replacement without discarding the entire fixture. Featuring weatherproof seals and a pre-aged bronze finish, this light offers reliable performance for pond, fountain and waterfall accents throughout the year.

FEATURES & BENEFITS

- **Solid Brass Construction**
Rust-proof, corrosion-resistant, UV-resistant bronze finish that won't fade over time.
- **Shockproof Glass Lens**
Fastened with rust proof screws.
- **Well-sealed Silicone O-ring**
Keeps water and dusts out.
- **Heavy Brass Base**
Corrosion resistance and good load-bearing performance.
- **25FT Extra-long Cable**
Adapts to complex terrains and offers detour possibilities.
- **Replaceable Bulb Design**
Supports halogen or LED MR16 bulbs for flexible.
- **Flexible Adjustment**
The head is 270° adjustable, allowing for precise aiming of the 45° beam.



Gardenreet® Premium Brass Landscape Lighting
Brass Pond Light – Classic Model: Pondlight-2801

PRODUCT SPECIFICATIONS

- **Construction:** Solid Brass
- **Finish:** Antique Bronze
- **Socket Type:** GU5.3
- **Wattage:** 5W
- **Voltage:** 12V AC/DC
- **Waterproof Rating:** IP68
- **Operating Temperature:** -49°C to 113°C
- **Lens:** Frosted
- **Lead Wire:** 25" 2×16AWG
- **Mounting:** Flush Mount
- **Compatible Transformer:** Low Voltage 12V Landscape Transformer (Not Included)

BASIC COMPONENTS INCLUDED

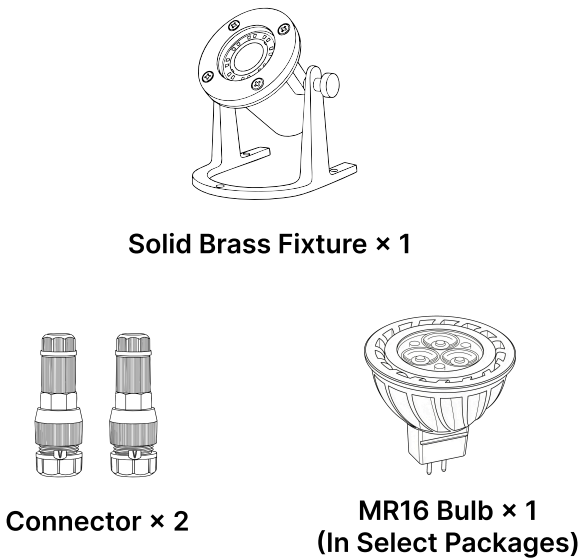

PRODUCT DIMENSIONS

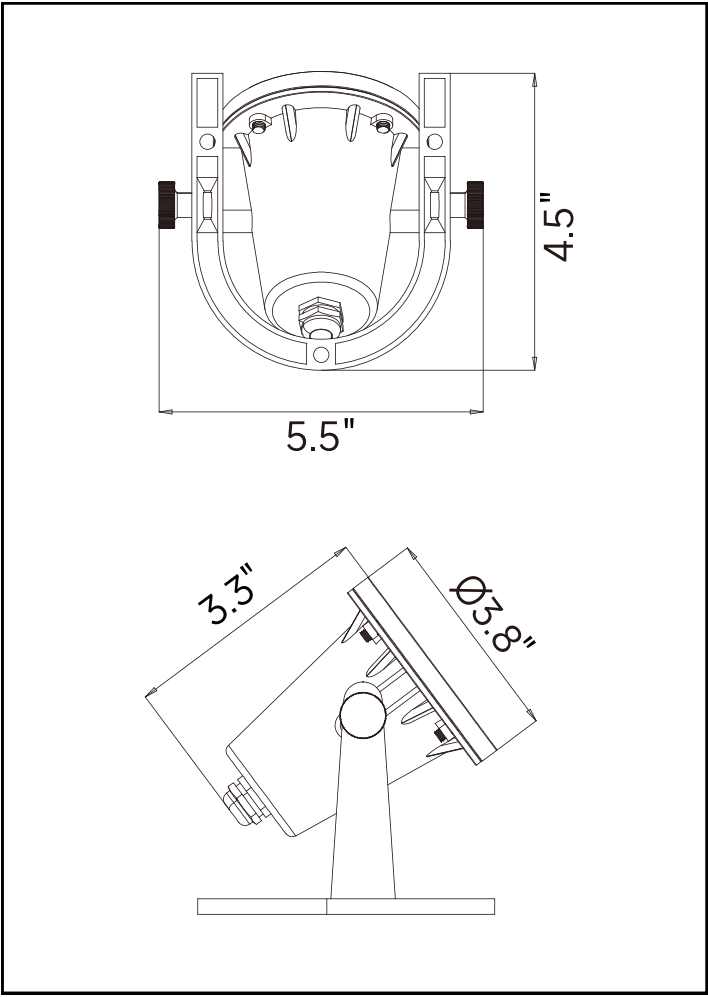

ELECTRICAL FEATURES

The fixture uses **UL-certified 2×16AWG brass-shrouded wiring** with tinned copper ends for enhanced corrosion resistance. Compatible with both **LED bulbs**, it supports up to **20W output** and ensures stable performance across **AC/DC 12V** systems.